

Price list

Current at 11:55 AM 03 May 2024



Icaria - The Glades

Lot No.	Stage	Street Name	Area (m ²)	Frontage (m)	Titles	Price (\$)	Notes
36	14	Waratah Lane	519	15.0	Jul 2024	\$279,000 *	

Village Centre - The Glades

Lot No.	Stage	Street Name	Area (m ²)	Frontage (m)	Titles	Price (\$)	Notes
3106	VC2	Veterans Drive	281	9.4	Jul 2024	\$206,000	

Beaufortia Retreat - The Glades

Lot No.	Stage	Street Name	Area (m ²)	Frontage (m)	Titles	Price (\$)	Notes
3009	1	Warrington Road	510	17.0	Oct 2024	\$326,000 #	
3010	1	Warrington Road	450	15.0	Oct 2024	\$311,000 #	
3011	1	Warrington Road	450	15.0	Oct 2024	\$311,000 #	
3012	1	Beaufortia Retreat	553	15.0	Oct 2024	\$331,000 #	
3013	1	Beaufortia Retreat	407	15.0	Oct 2024	\$294,000 #	
3014	1	Beaufortia Retreat	559	19.6	Oct 2024	\$329,000 #	

Price includes front yard landscaping and side & rear fencing.
Prices shown are inclusive of GST and subject to change without notice.

BAL rating applies

* Quiet House Design requirement

Resale lots are excluded from any promotion or incentive Satterley may offer from time to time

Written finance pre-approval from a finance broker or financial institution is required prior to purchase. A \$3,000 deposit is required at time of signing an Offer & Acceptance.

For more information, email byford@satterley.com.au or call: 0475 560 570

byford.com.au
0475 560 570



Icaria Stage 14

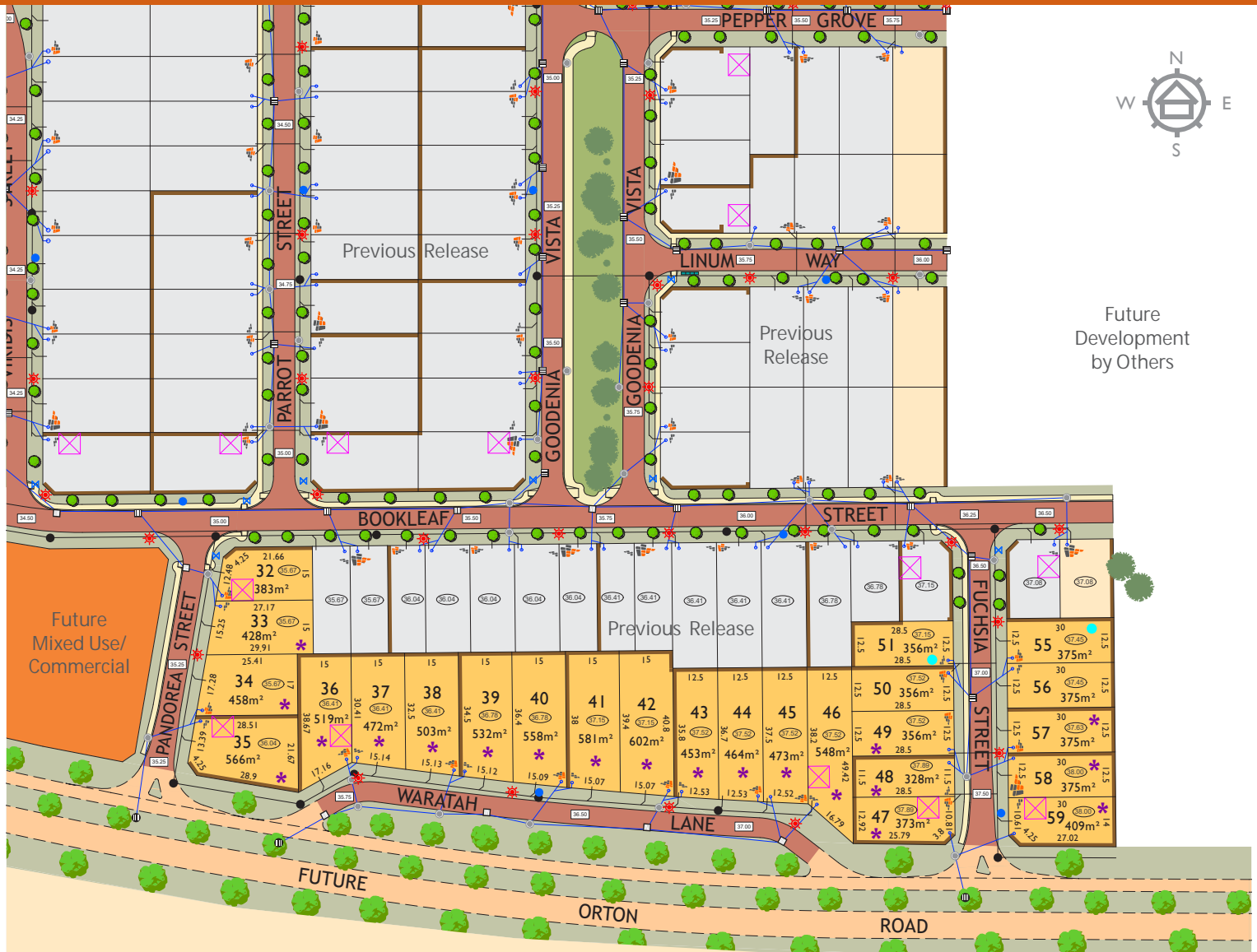

Future Development by Others

Future Development

Preliminary



Stage 14 (R25 Lots)	Previous Release	Future Development	Future Mixed Use/Commercial
---------------------	------------------	--------------------	-----------------------------

LEGEND			
Red Asphalt	Drainage Grate	Western Power Mini Pillar & Connection	Limestone Retaining Wall
Brick Paving	Side Entry Pit	Western Power Uni Pillar & Connection	Sewer Housing Connection/Manhole
Future Road	Drainage Manhole	Street Lights	Indicative Tree
Footpath	Stormwater Junction Connection	Western Power Padmount Site	Retained Tree
Water Valve	Water Hydrant	Road Level	Lot Level
		Garage Location	Quiet House Design
		Bushfire Attack Level BAL - 12.5	

Note 1 : Lots abutting laneways may be subject to a 1m x 1m Light Pole easement or road widening.

Note 2: This plan is indicative only and may be subject to change. All dimensions and areas are subject to survey. The particulars on this brochure are supplied for identification purposes only and shall not be taken as a representation in any respect on the part of the vendor or it's agents. Authorities should be consulted when services are contained within lot boundaries as building restrictions may apply. Some services may not be shown, as engineering design is still to be finalised. Selected existing trees to remain.

All Engineering, Electrical, Cadastral & Encumbrances are still to be designed and are subject to change.

Village Centre Stage 2



Preliminary

LEGEND

- Village Centre Stage 2 (R-60)
- Village Centre Stage 2 (R-80)
- Future Residential
- Existing Residential
- Existing Commercial

LEGEND

- Red Asphalt
- Brick Paving
- Footpath
- Lot Level
- Road Level
- Drainage Grate
- Side Entry Pit
- Drainage Manhole
- Stormwater Junction Connection
- Street Lights
- Western Power Mini Pillar & Connection
- Western Power Uni Pillar & Connection
- Western Power Below Ground Service Pit & Connection
- Western Power Padmount Site
- Sewer Housing Connection / Manhole
- Sewer Easement
- Limestone Retaining Wall
- Bus Stop
- Water Hydrant
- Water Valve
- Indicative Tree
- Existing Tree



Note 1 : Lots abutting laneways may be subject to a 1m x 1m Light Pole easement or road widening.

Note 2 : This plan is indicative only and may be subject to change. All dimensions and areas are subject to survey. The particulars on this brochure are supplied for identification purposes only and shall not be taken as a representation in any respect on the part of the vendor or its agents. Authorities should be consulted when services are contained within lot boundaries as building restrictions may apply. Some services may not be shown, as engineering design is still to be finalised.

Note 3: Street Names preliminary and subject to change

Note 4: Selected existing trees to remain.

All Engineering, Electrical, Cadastral & Encumbrances are still to be designed and are subject to change.



Beaufortia Retreat



Preliminary

Legend

- Beaufortia Retreat
- Existing Residential

Legend

- Red Asphalt
- Brick Paving
- Footpath
- Loc Level
- Road Level
- Western Power Mini Pillar & Connection
- Western Power Uni Pillar & Connection
- Western Power Padmount Site
- Street Lights
- Drainage Grate
- Side Entry Pit
- Drainage Manhole
- Stormwater Junction Connection
- Existing Tree
- Sewer Housing Connection /Manhole
- Limestone Retaining Wall
- Alt Fencing Treatment Retaining Wall
- Indicative Tree
- Water Hydrant
- Water Valve
- Bushfire Attack Level
- BAL - 12.5
- BAL - 19

Note 1 : Lots abutting laneways may be subject to a 1m x 1m Light Pole easement or road widening.

Note 2 : This plan is indicative only and may be subject to change. All dimensions and areas are subject to survey. The particulars on this brochure are supplied for identification purposes only and shall not be taken as a representation in any respect on the part of the vendor or it's agents. Authorities should be consulted when services are contained within lot boundaries as building restrictions may apply. Some services may not be shown, as engineering design is still to be finalised.

Note 3: Street Names preliminary and subject to change

Note 4: Selected existing trees to remain.

All Engineering, Electrical, Cadastral & Encumbrances are still to be designed and are subject to change.

